

SINCE 1935

HENZELLS

AGENCY

\$10,600 P/A + Outgoings + GST



BRAND NEW TILT PANEL UNIT

17 / 34-36 Claude Boyd Parade, Bells Creek

Exciting opportunity to secure a brand new quality tilt panel in Bells Creek Business Park II, in the sought-after Sunshine Coast Industrial Estate.

- ~ BELLS CREEK BUSINESS PARK II is a new gated industrial complex
- ~ Cost effective with ease of access to Bruce Hwy and Caloundra
- ~ Medium Impact zoning caters for a range of business usages
- ~ Ideal for personal storage e.g. motor homes, boats etc.
- ~ Quality kitchenette, bathroom and 3 phase power

AREA: Warehouse: 82sqm (approx.)

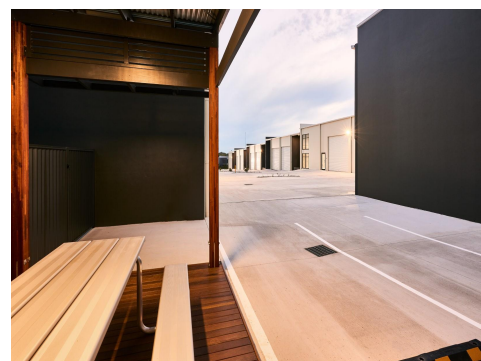
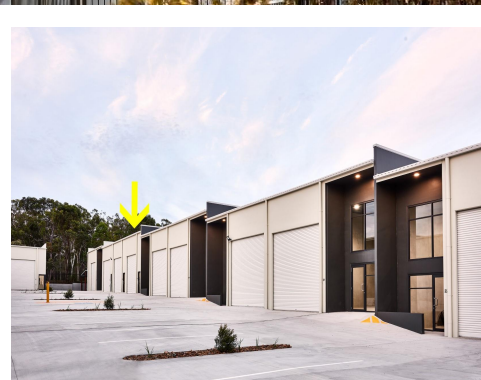

Paul Bell

phone 0754912000
mobile 0400711969



Jayden Mobbs

phone 07 5491 2000
mobile 0434 794 600

